

\*Details should be considered indicative only. Intellectual Property of SBUK.

PU Adhesive

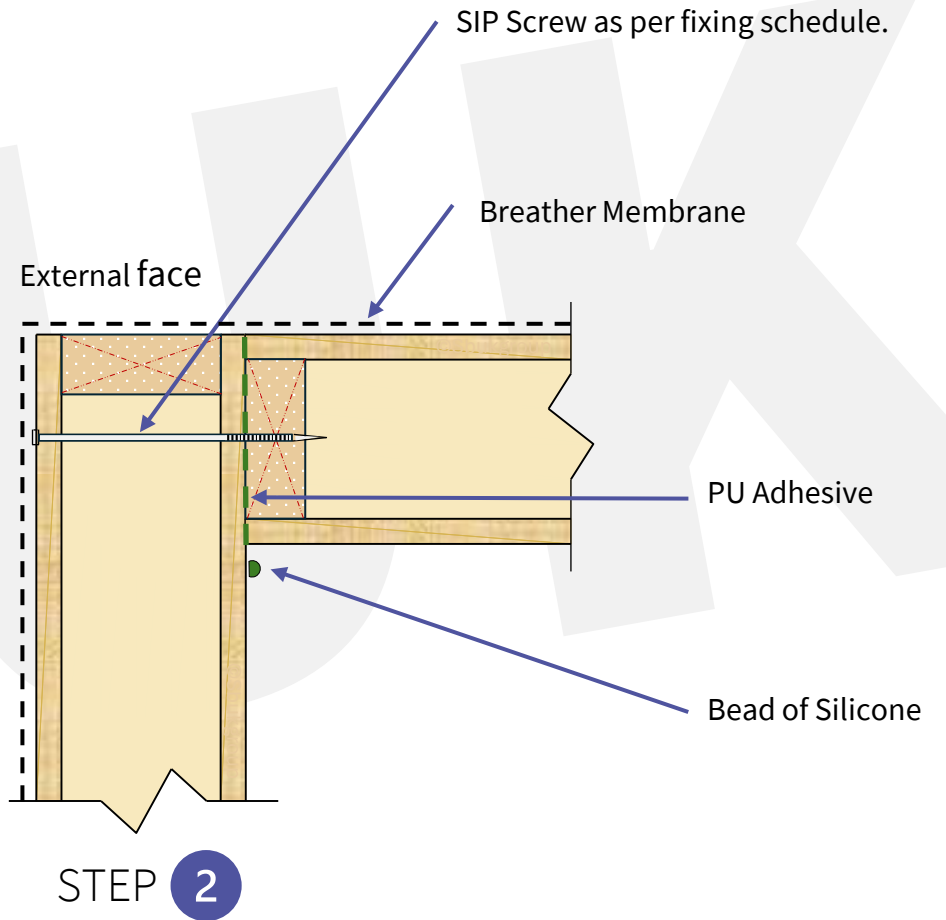
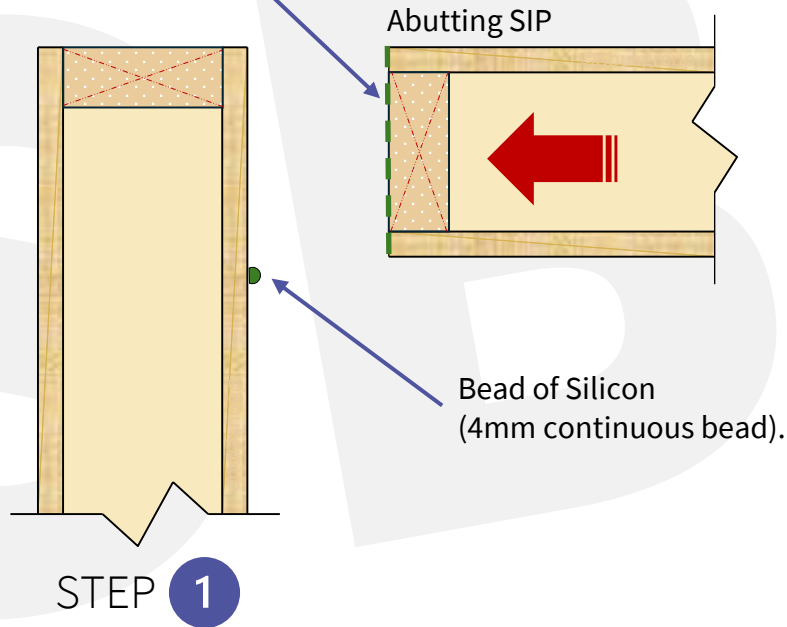

ALL CAPPING TIMBERS FIXED INTO REBATES AS PER DETAIL

**SD-01**

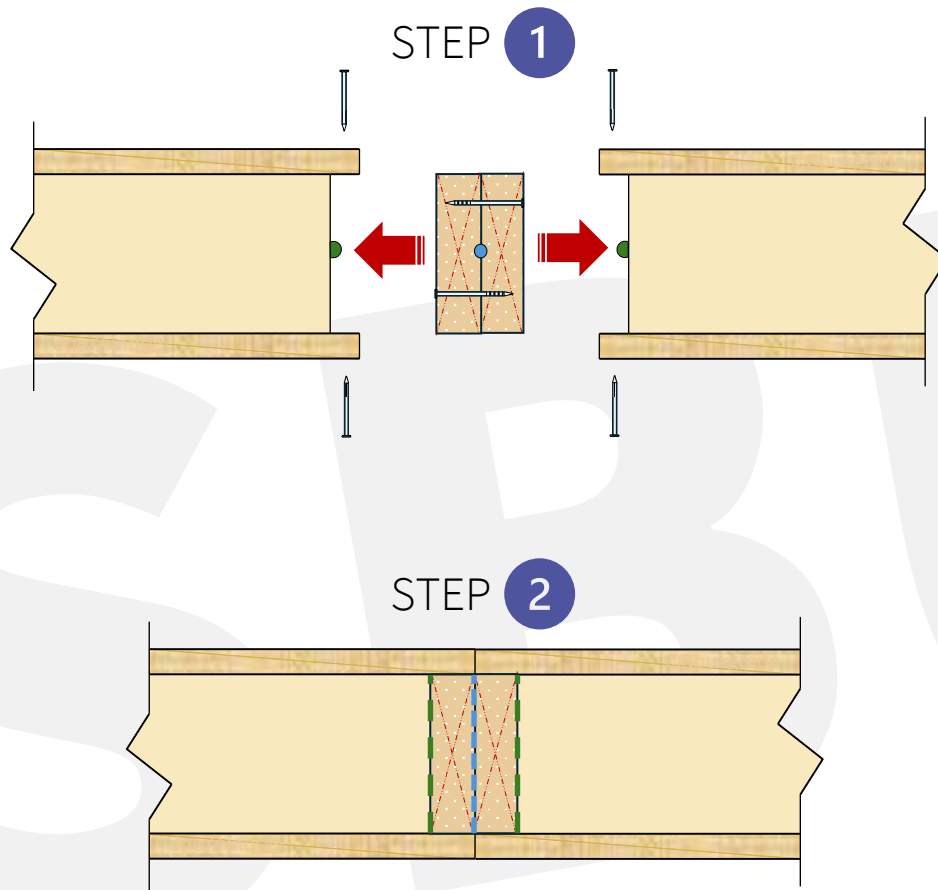

Timber joints to be either:

1 No. Solid Timber

or;

2 No. Timbers (nailed and glued).

When fully nailing Timbers, Glue is also to be used.

**NO EXCEPTIONS**

Solid Timber



2 no Rebate Timbers

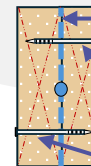

Bead of PU Adhesive along one timber face prior to abutment.

Nails as per fixing schedule.

**\*ALL SIPs REBATES PREPARED AS PER DETAIL**

**SD-01**

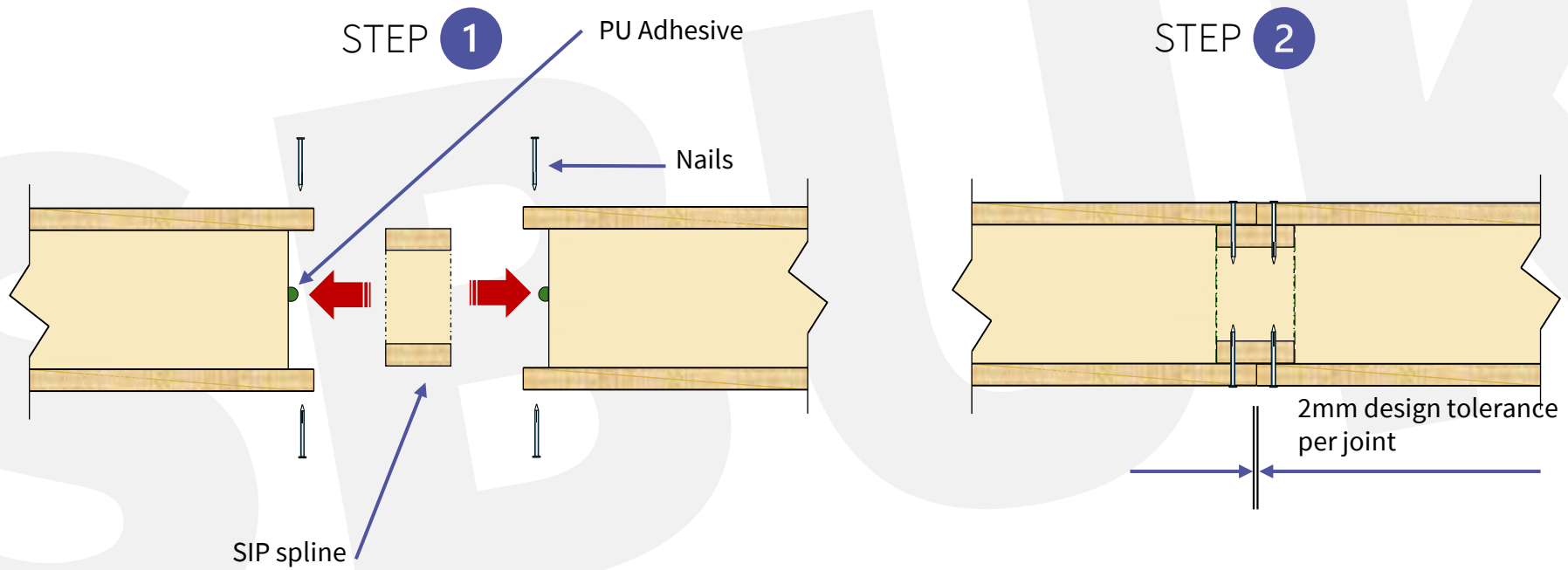

\*ALL SIPs REBATES PREPARED AS PER DETAIL **SD-01**

\*Details should be considered indicative only. Intellectual Property of SBUK.

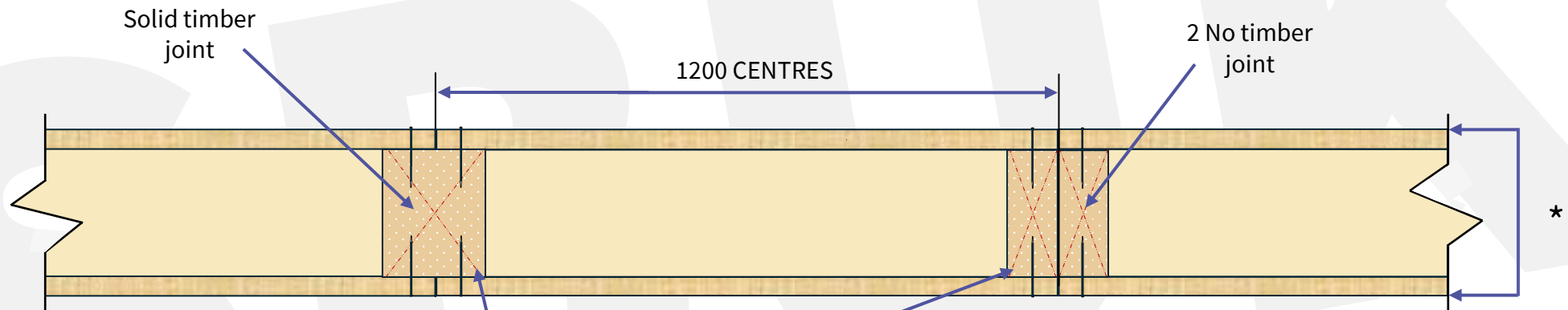

Timber joints to be either:  
1 No. Solid Timber  
or;  
2 No. Timbers (nailed and glued).  
When fully nailing Timbers, Glue is also to be used.  
NO EXCEPTIONS

\*SIP size

100, 125, 142, 150, 172, 175, 200, 225 mm

\*Details should be considered indicative only. Intellectual Property of SBUK.

AS PER STA GUIDANCE SIPS SPRINGING LEVEL MIN 150MM ABOVE EXTERNAL GROUND LEVEL.

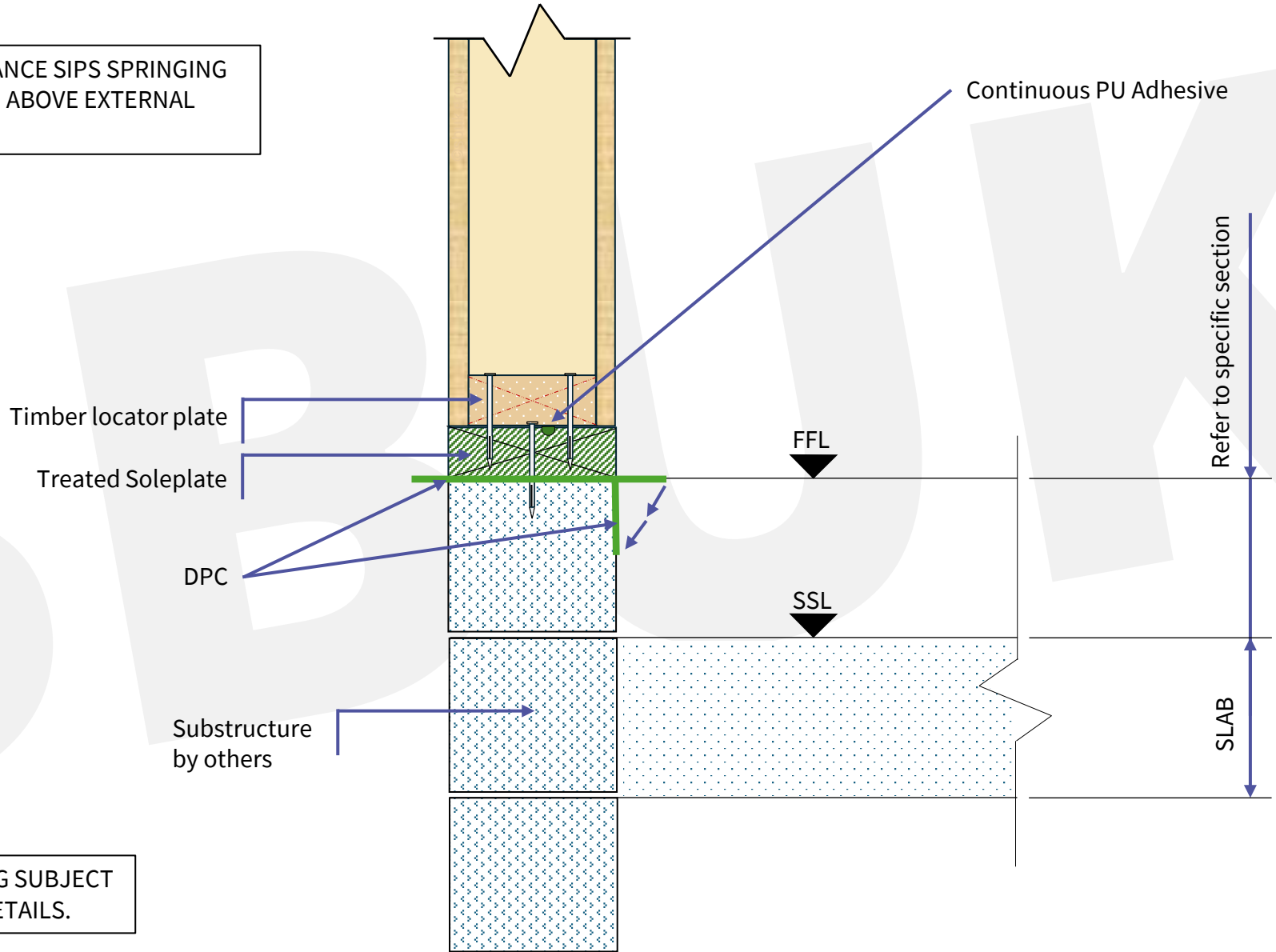

DPC POSITIONING SUBJECT TO CLIENT DETAILS.

\*Details should be considered indicative only. Intellectual Property of SBUK.

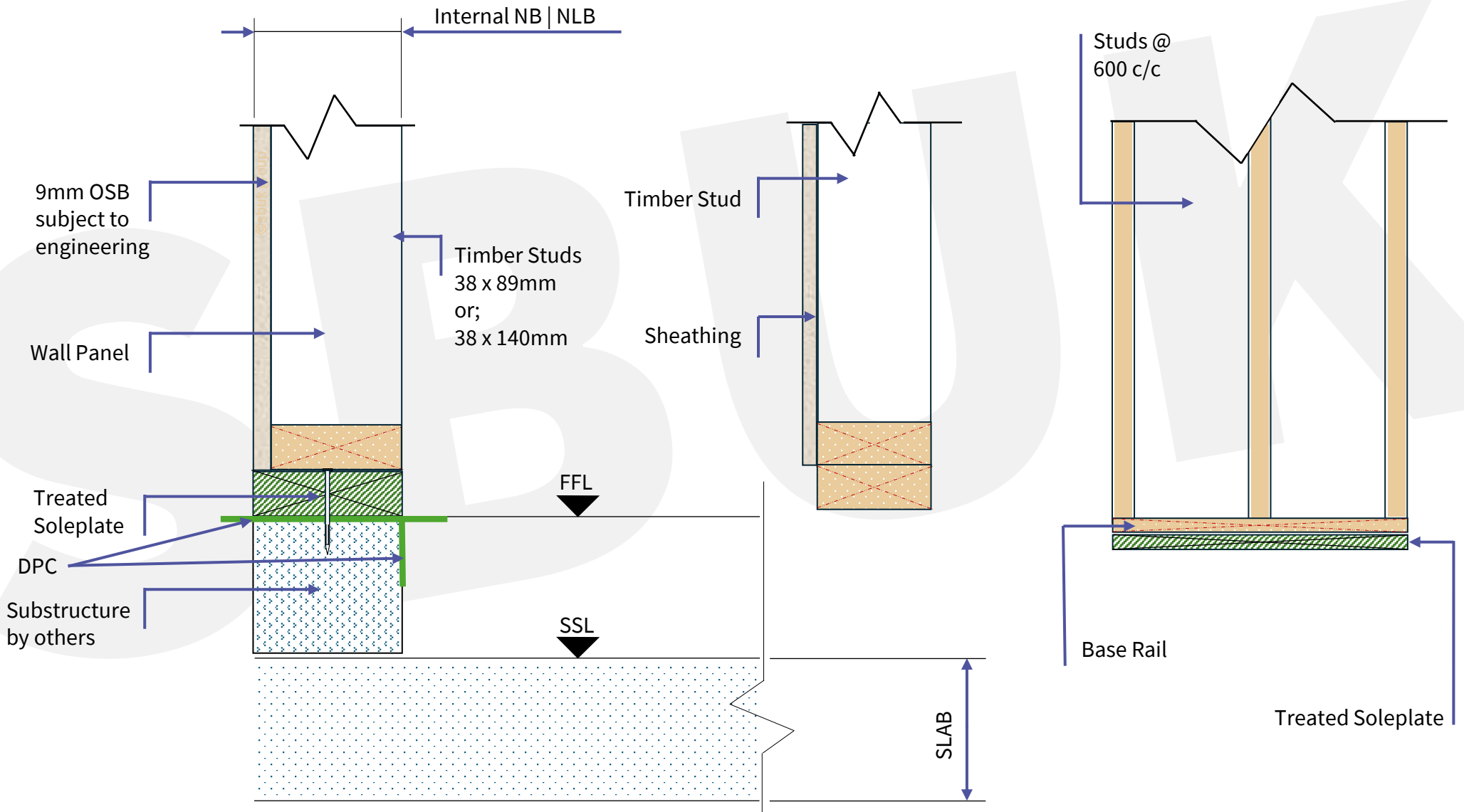

\*Details should be considered indicative only. Intellectual Property of SBUK.

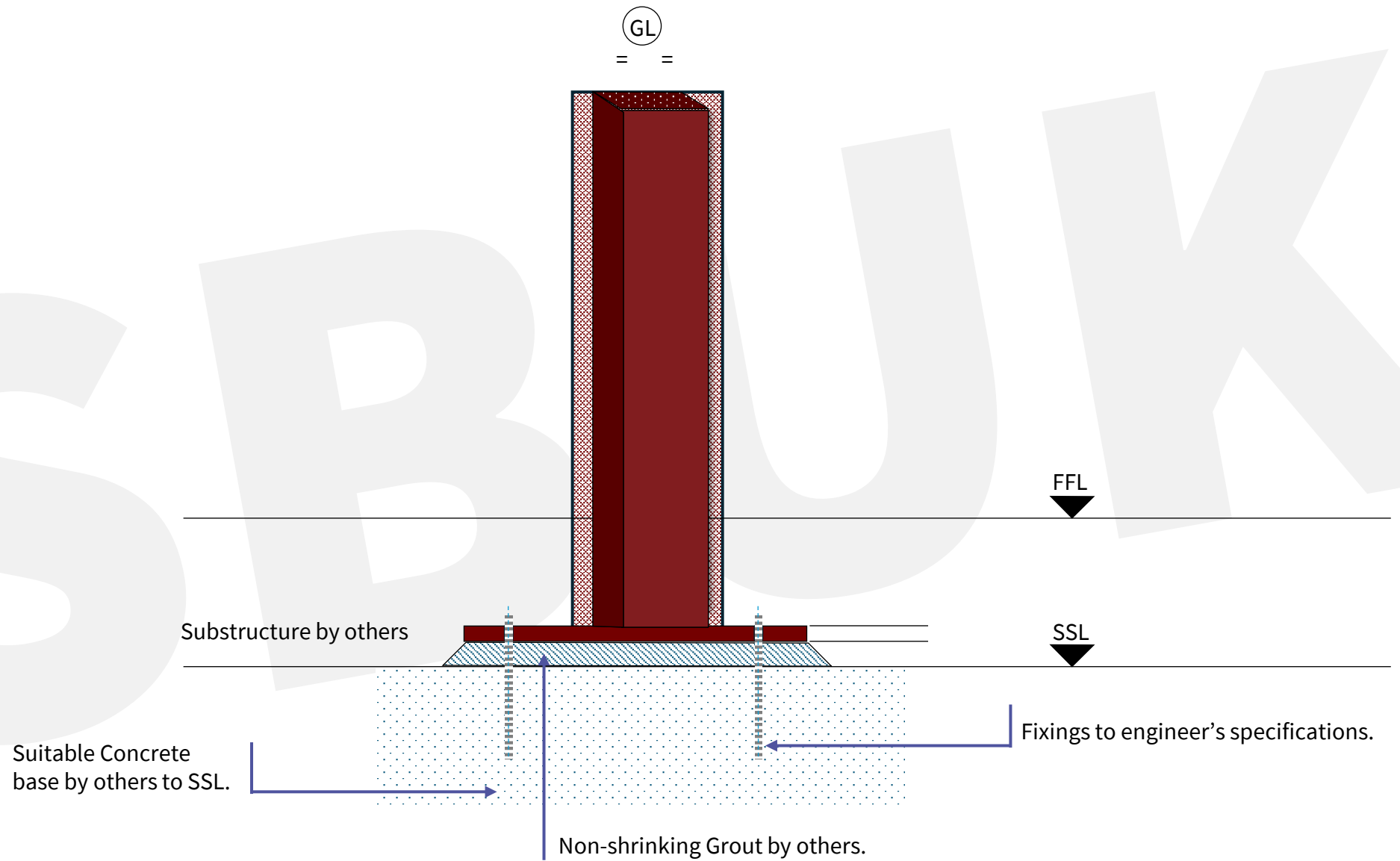

\*Details should be considered indicative only. Intellectual Property of SBUK.



PLAN VIEW

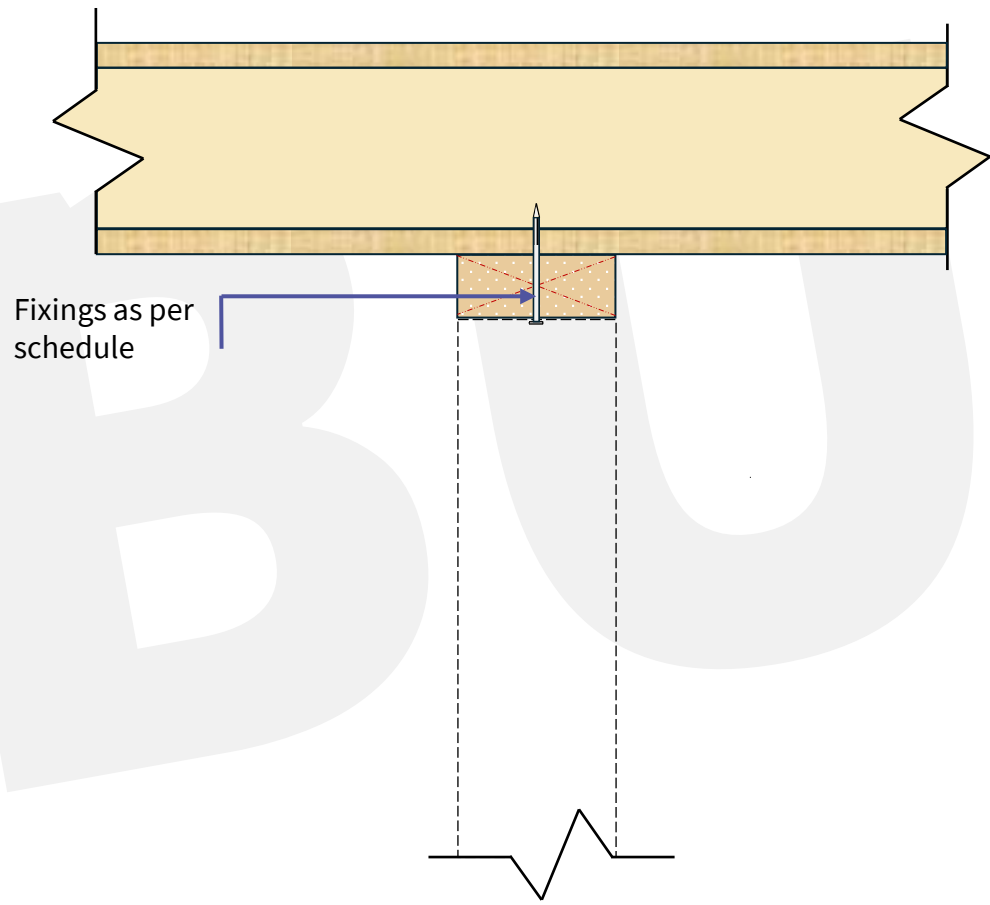

\*Details should be considered indicative only. Intellectual Property of SBUK.

PLAN VIEW

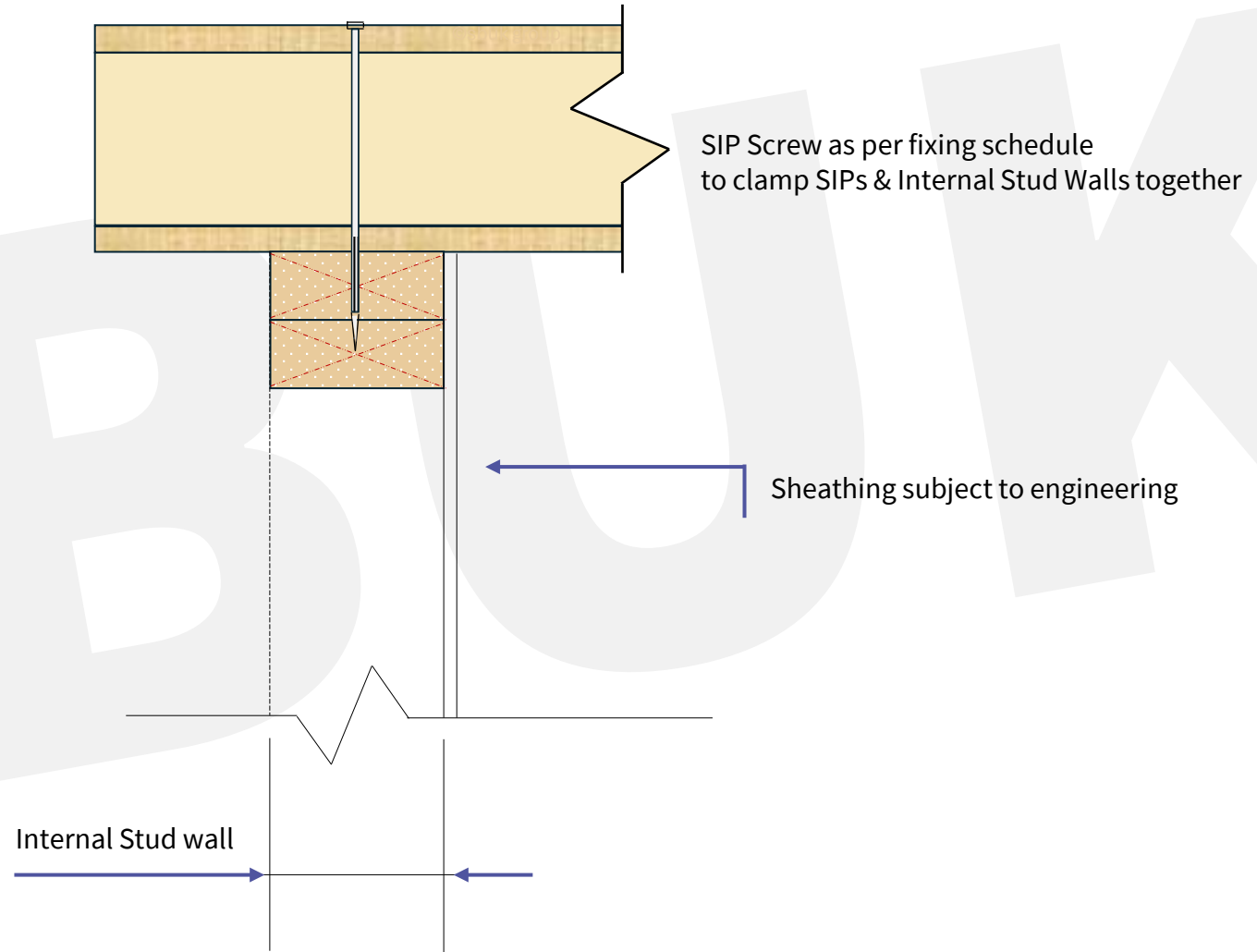

\*Details should be considered indicative only. Intellectual Property of SBUK.

Internal Walls  
PLAN VIEW

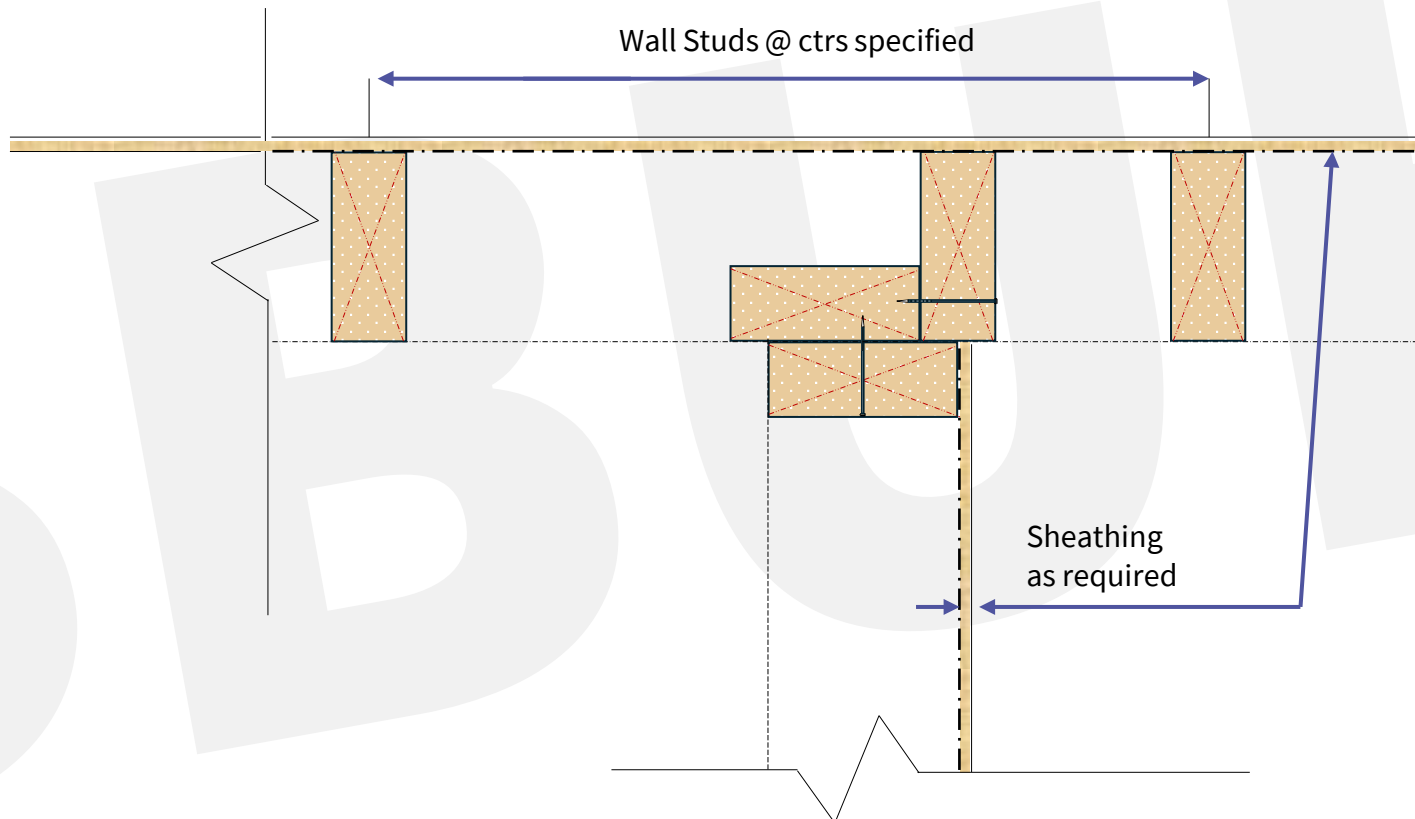

\*Details should be considered indicative only. Intellectual Property of SBUK.

PLAN VIEW

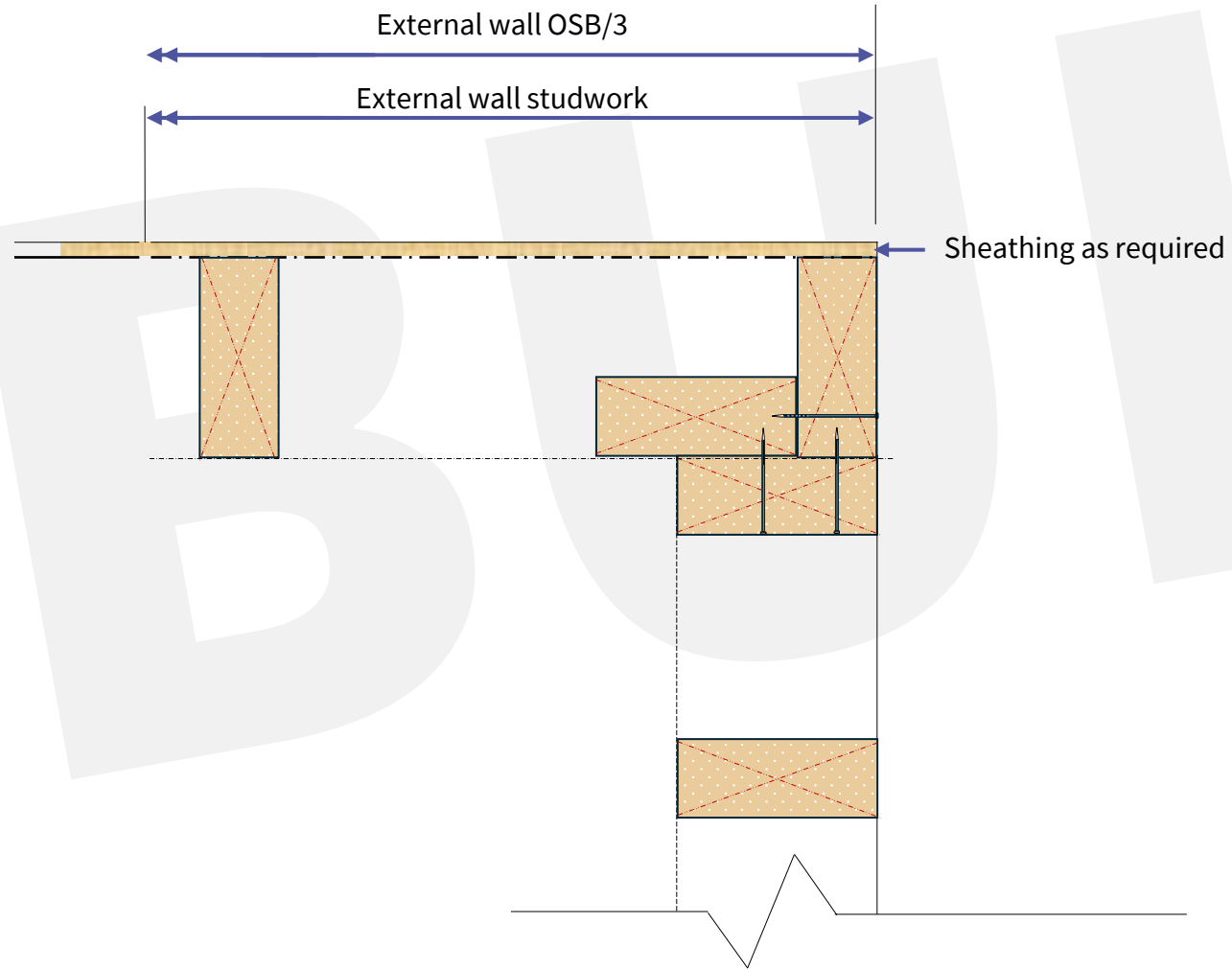

\*Details should be considered indicative only. Intellectual Property of SBUK.

PLAN VIEW

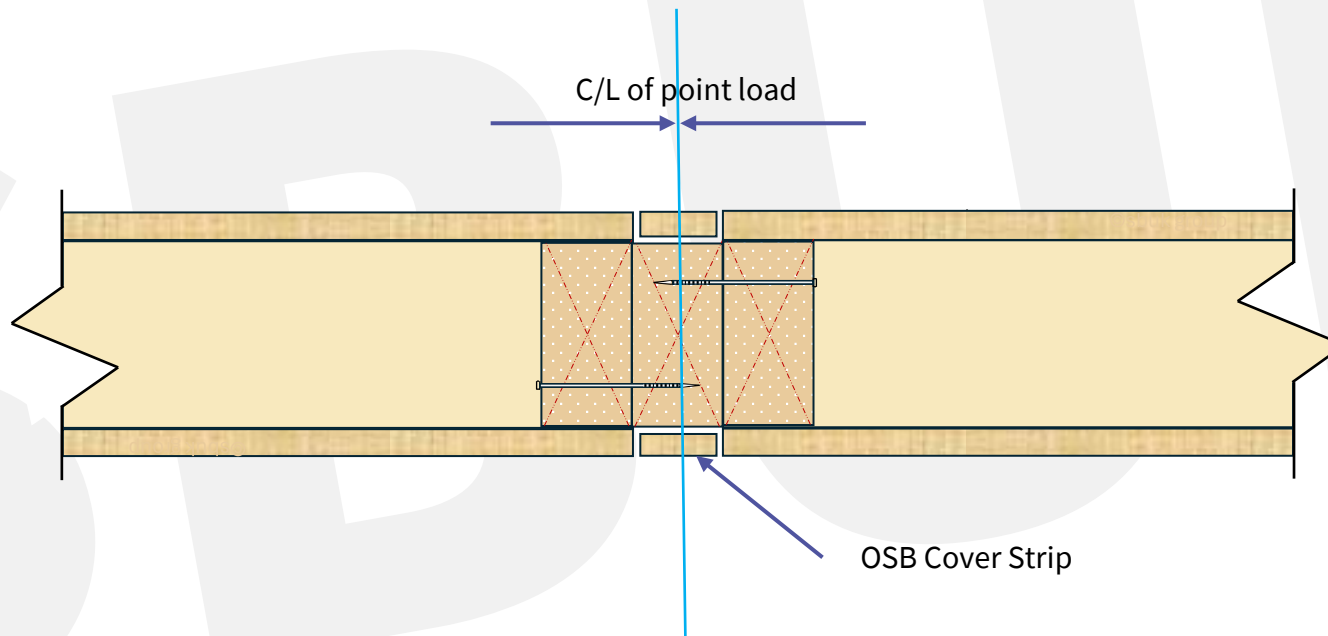

\*Details should be considered indicative only. Intellectual Property of SBUK.

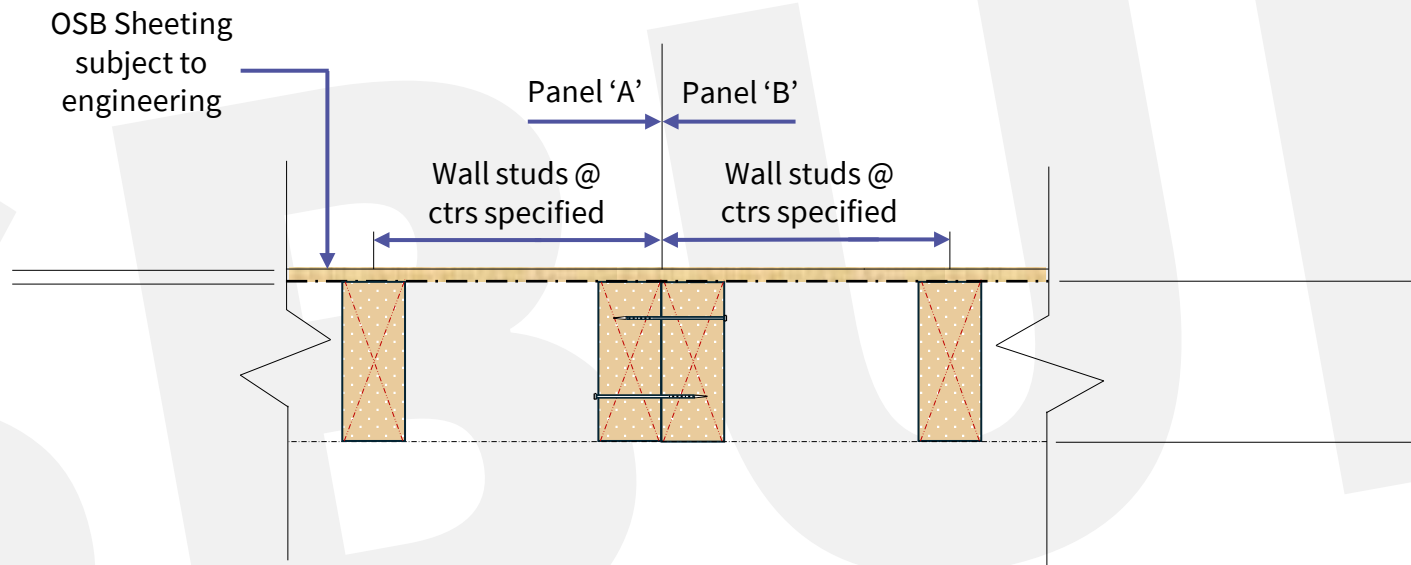

\*Details should be considered indicative only. Intellectual Property of SBUK.

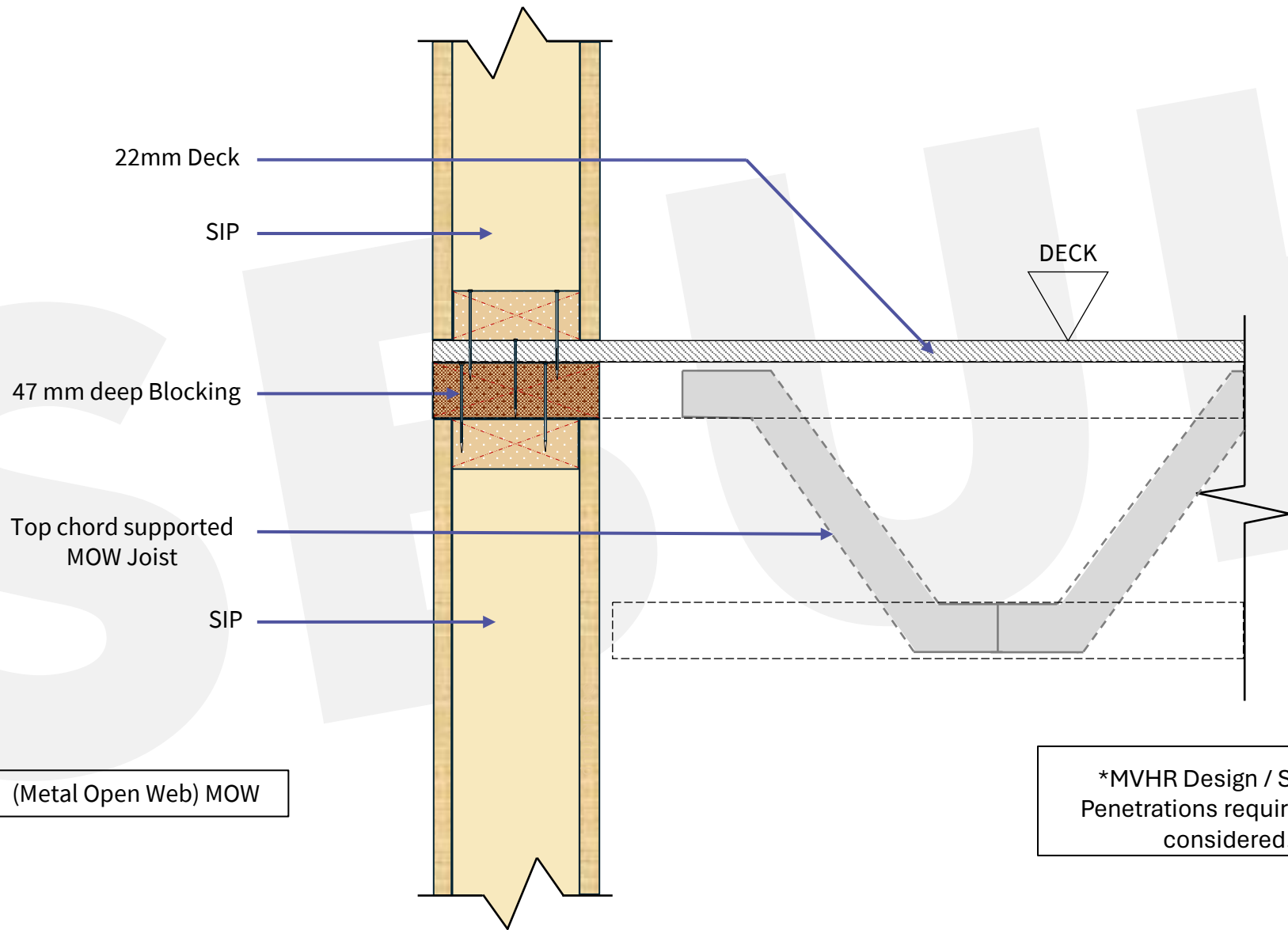

\*Details should be considered indicative only. Intellectual Property of SBUK.

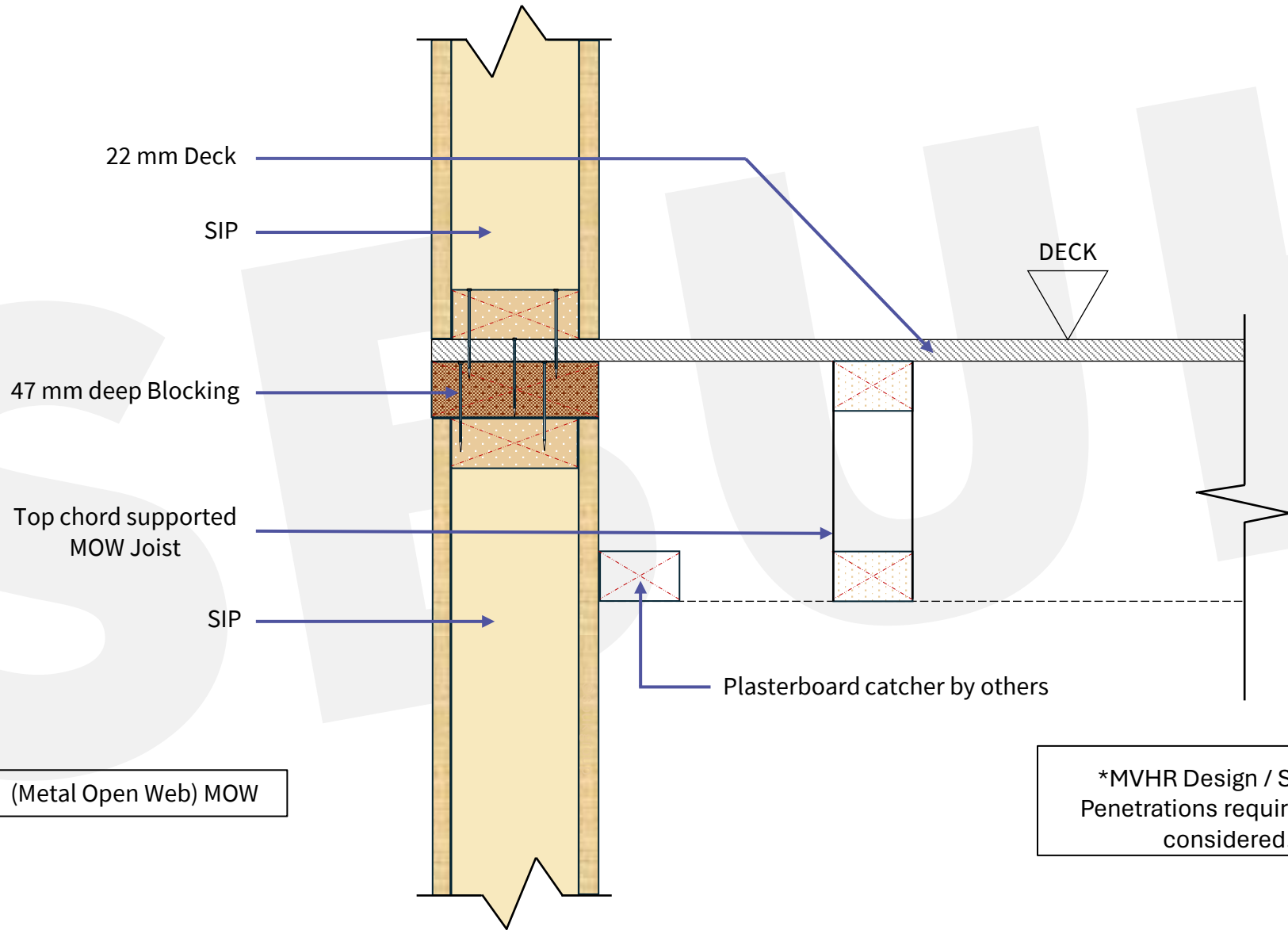

(Metal Open Web) MOW

\*MVHR Design / Service Penetrations required to be considered.

\*Details should be considered indicative only. Intellectual Property of SBUK.



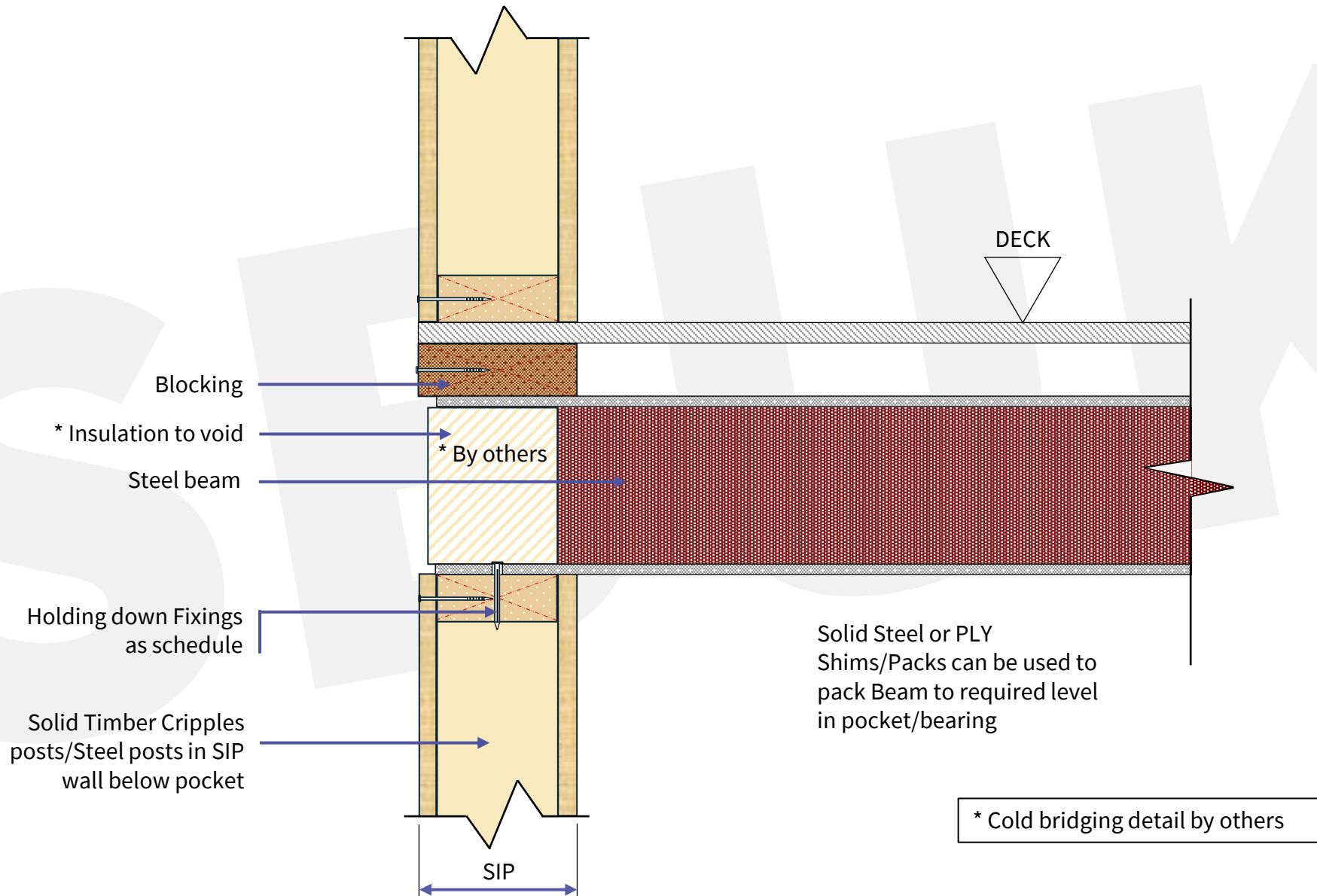

\*Details should be considered indicative only. Intellectual Property of SBUK.

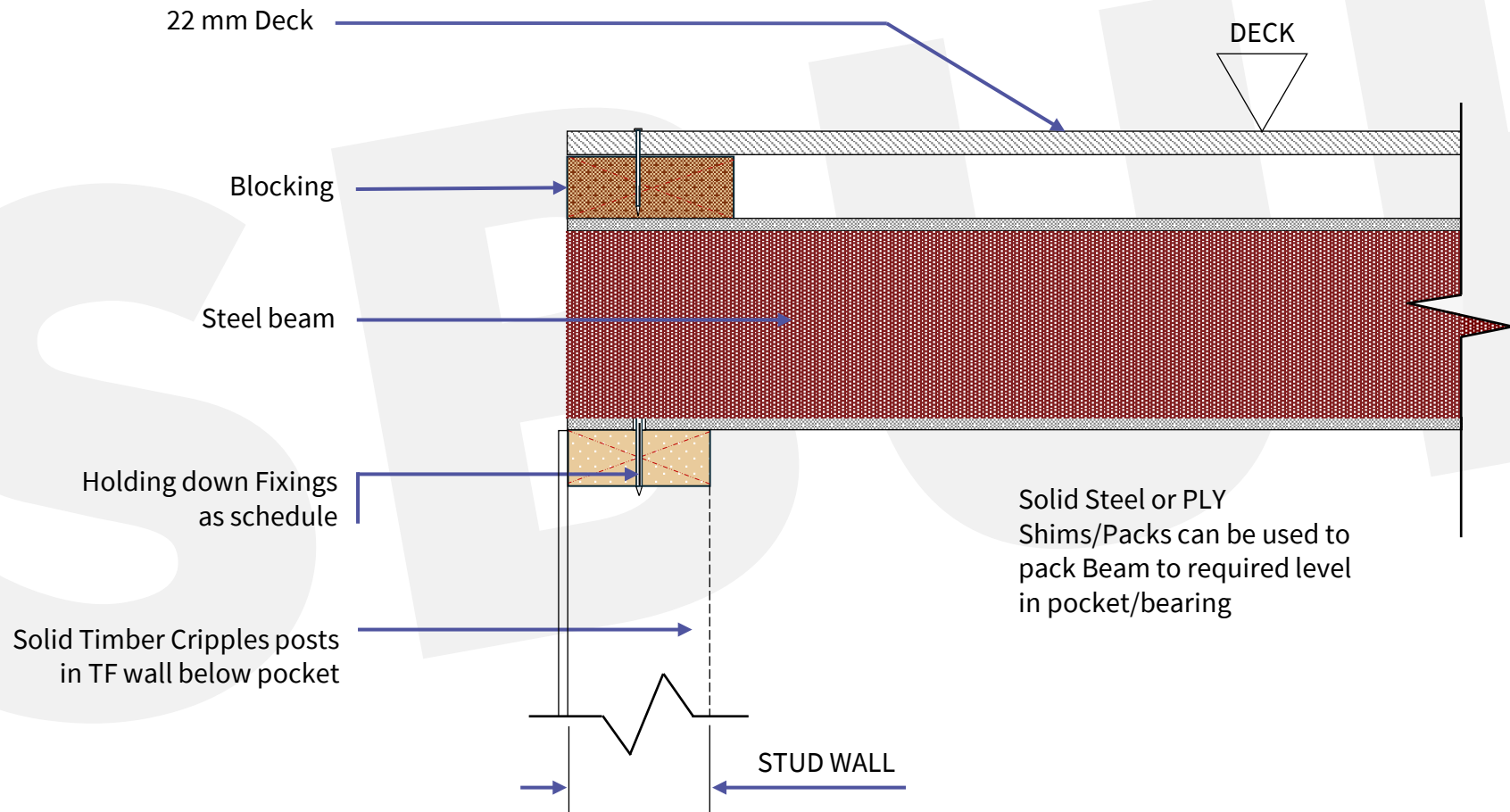

\*Details should be considered indicative only. Intellectual Property of SBUK.

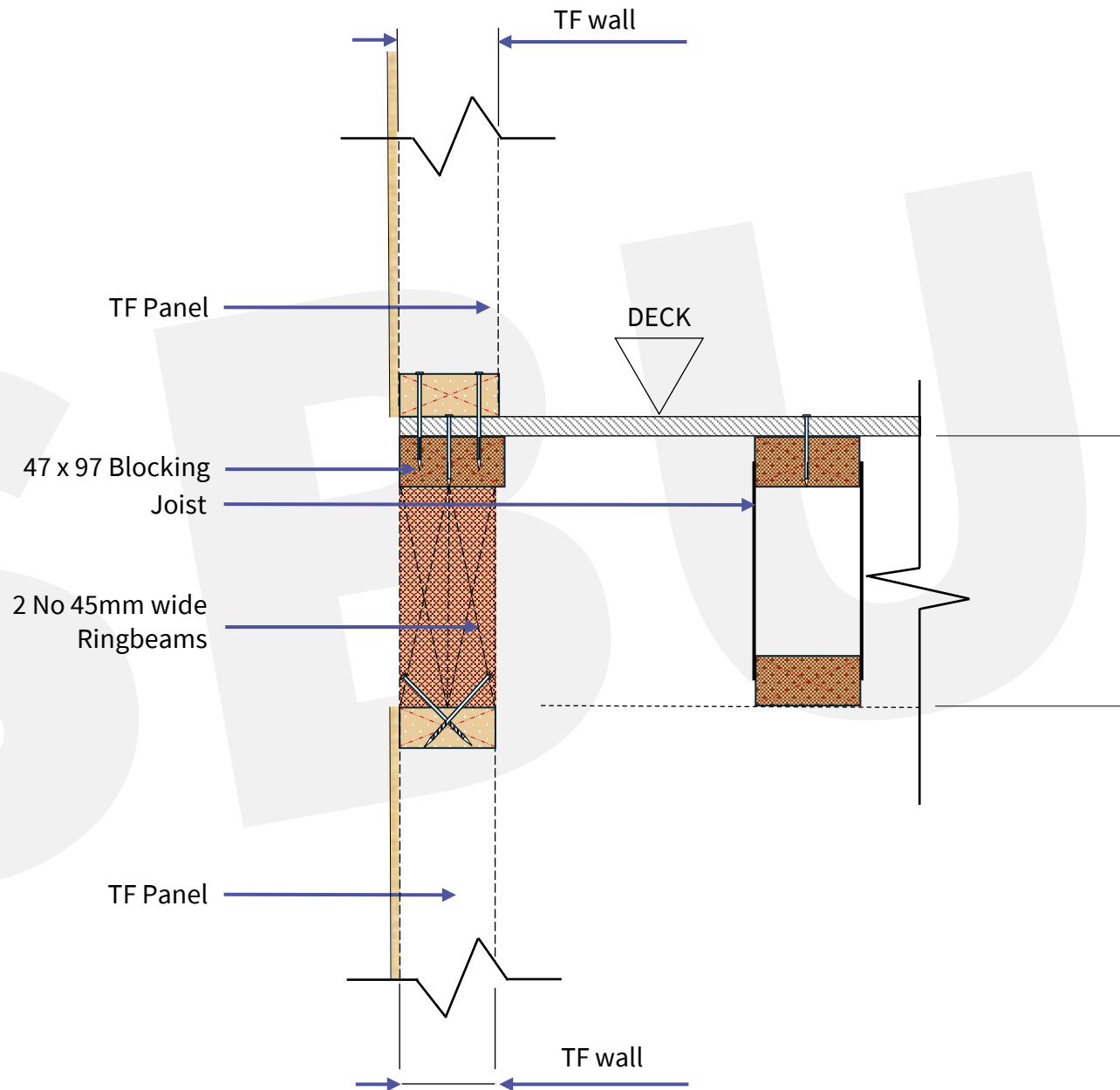

\*Details should be considered indicative only. Intellectual Property of SBUK.

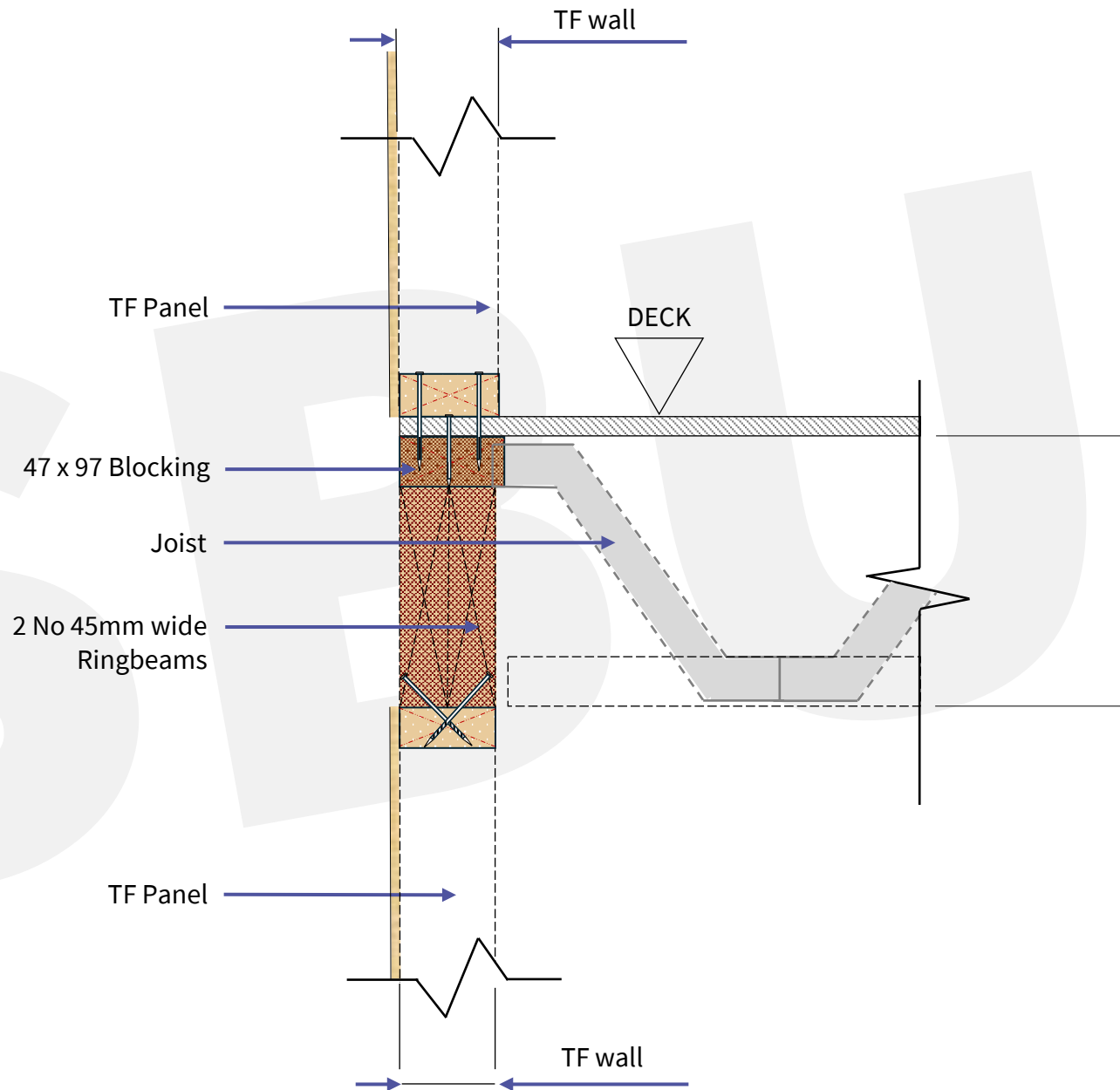

\*Details should be considered indicative only. Intellectual Property of SBUK.

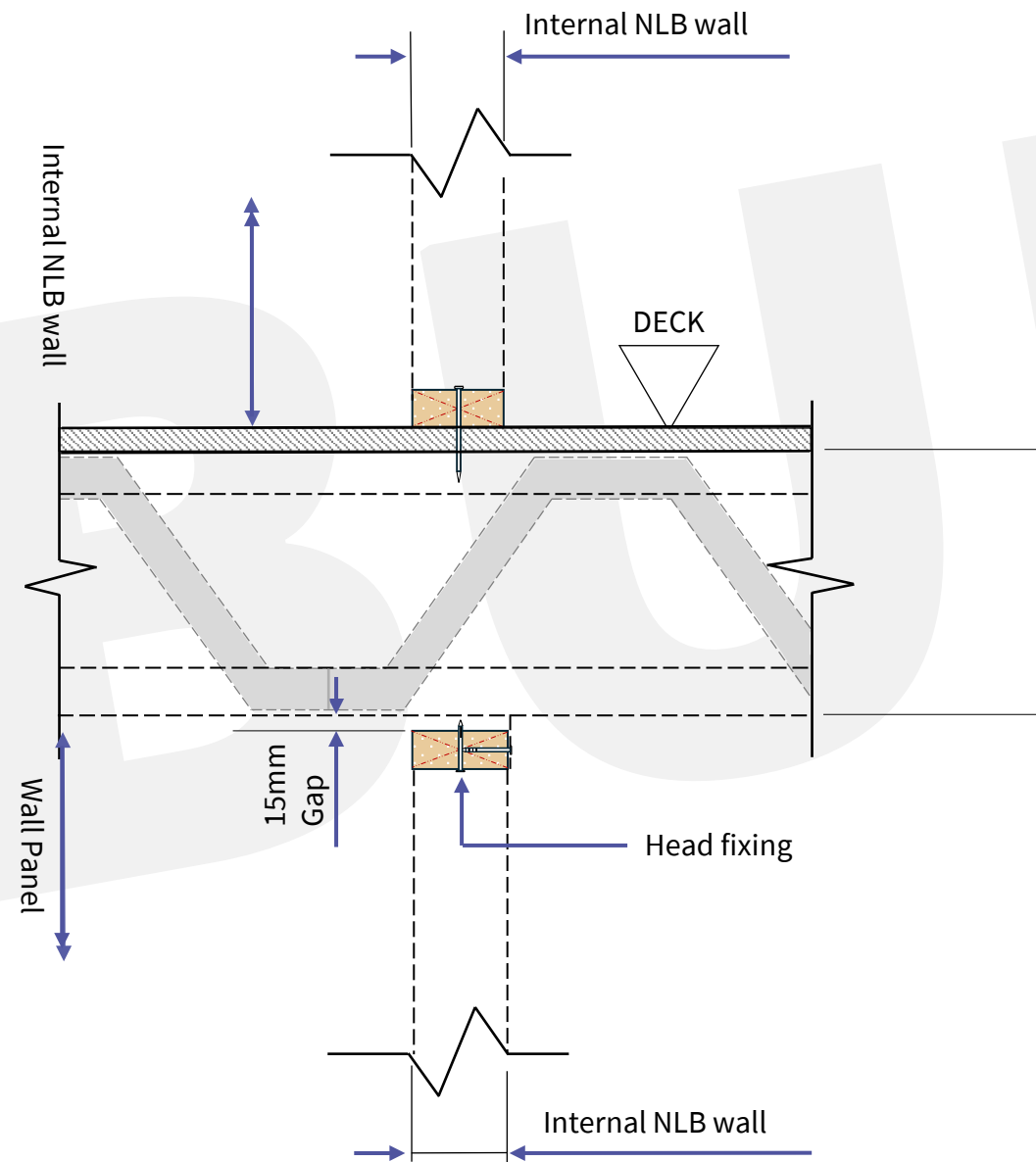

\*Details should be considered indicative only. Intellectual Property of SBUK.

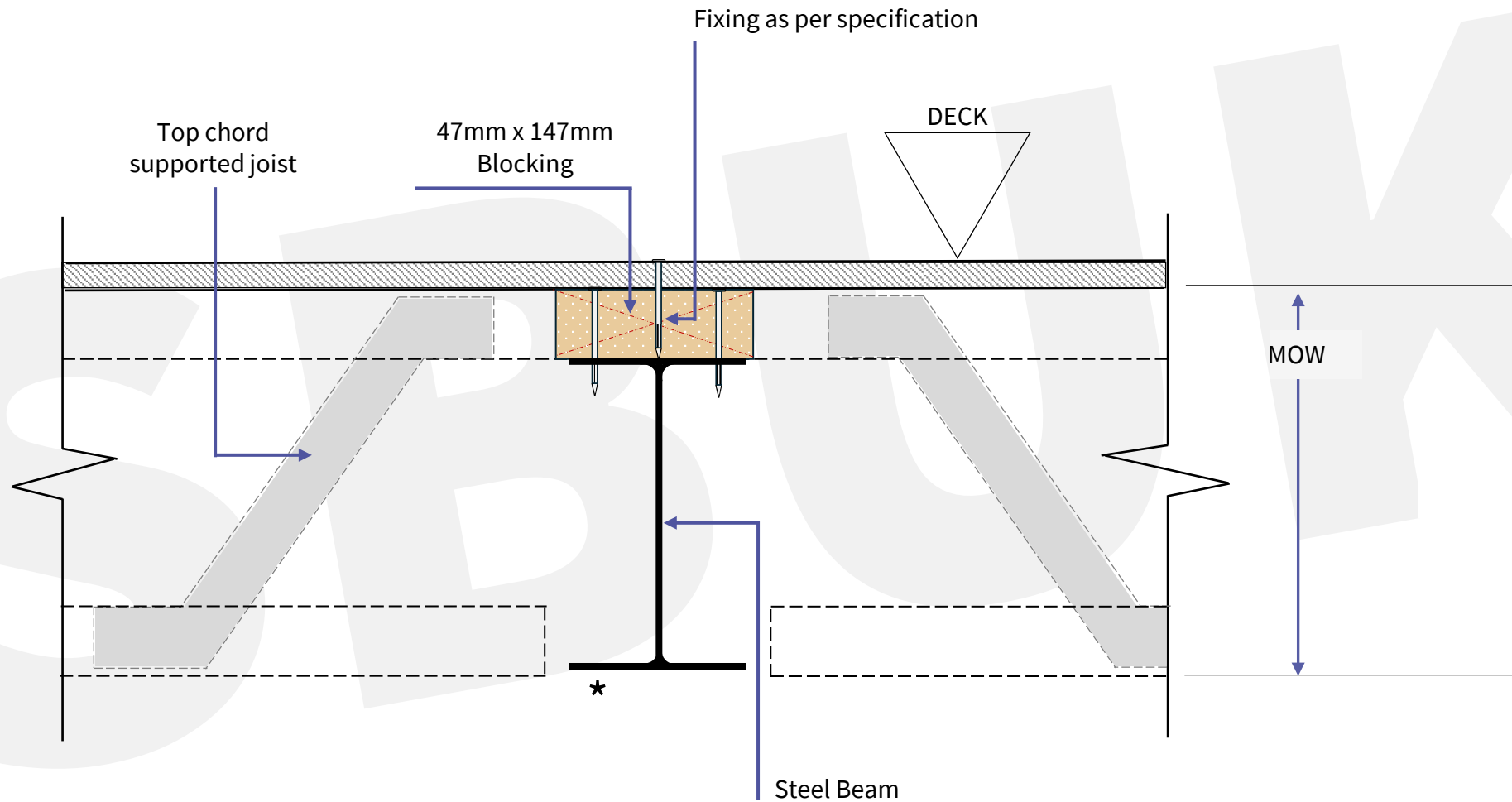

\* Potential downstand subject to engineered beam sizes

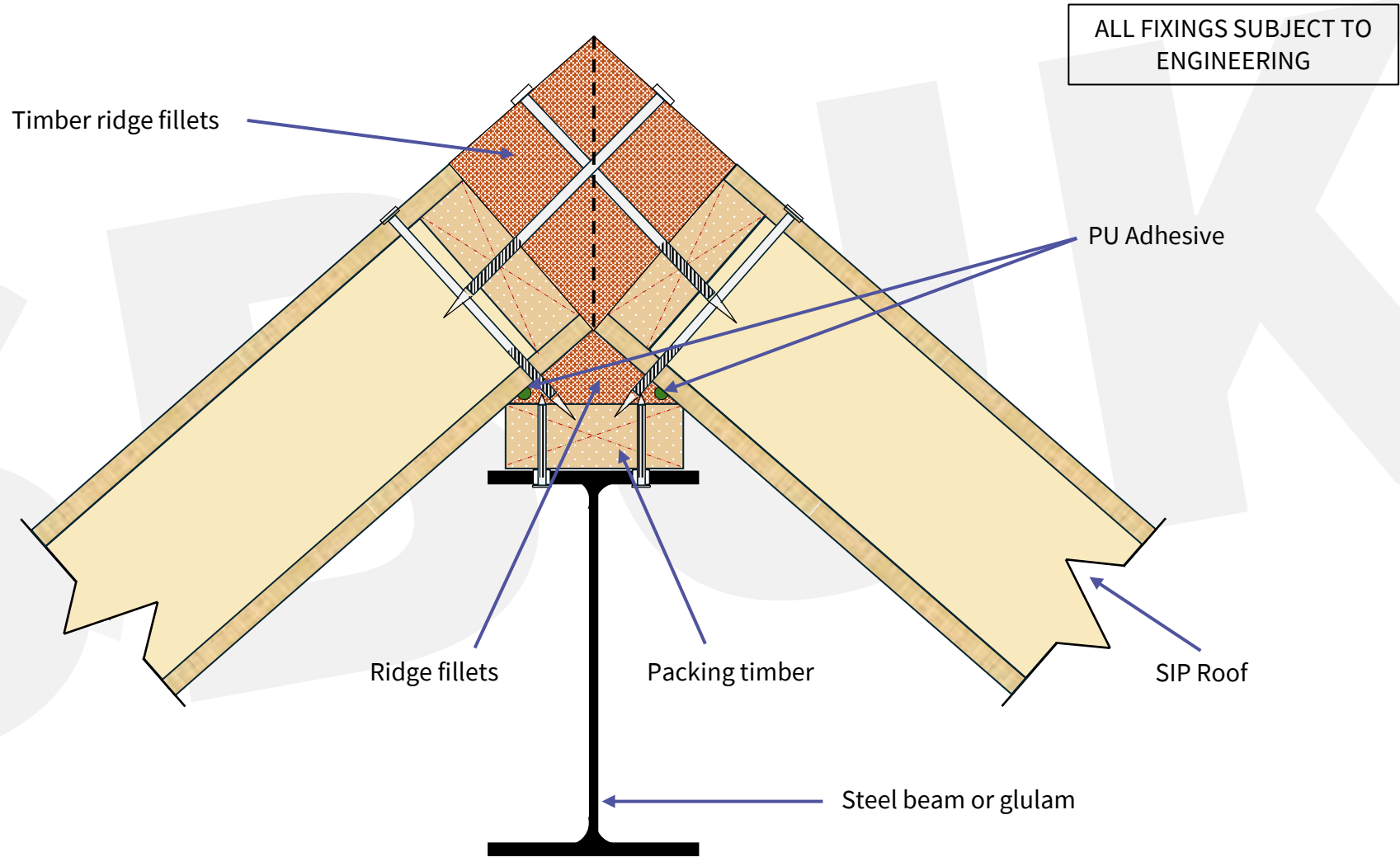

\*Details should be considered indicative only. Intellectual Property of SBUK.

Rafter extensions  
profiled by others  
when required

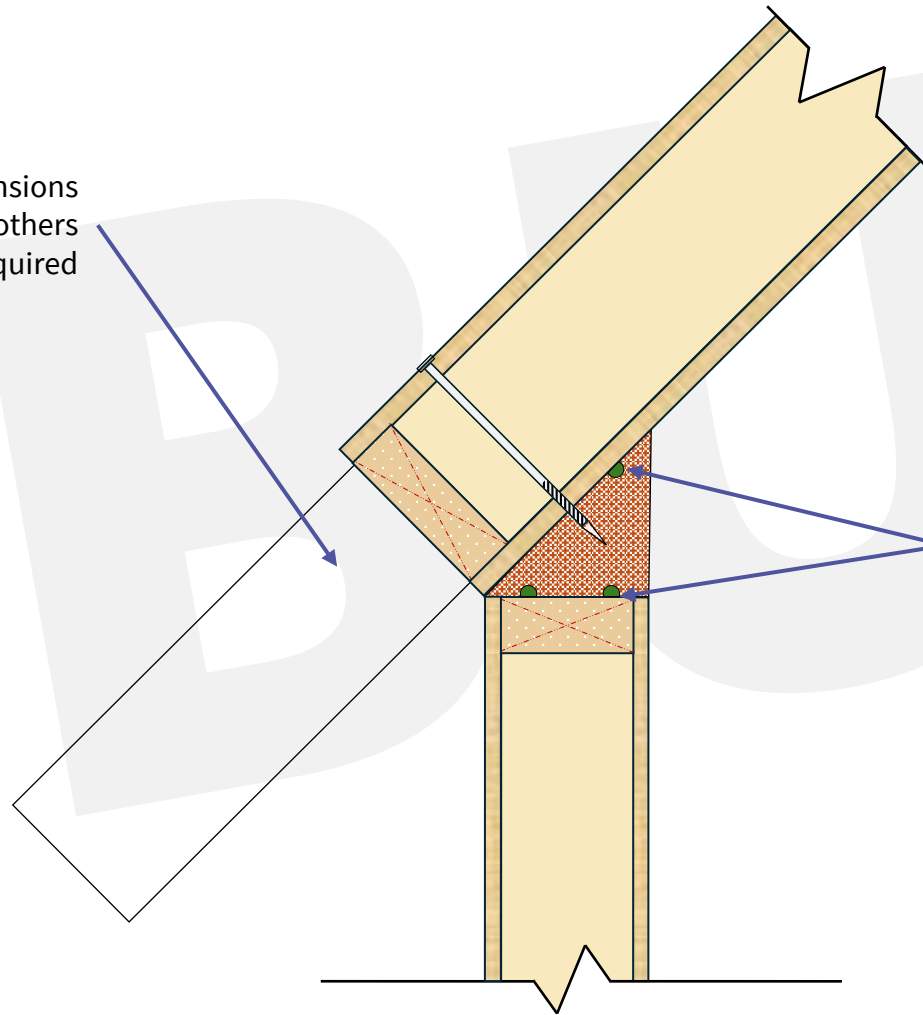

ALL FIXINGS SUBJECT TO  
ENGINEERING

PU Adhesive

\*Details should be considered indicative only. Intellectual Property of SBUK.



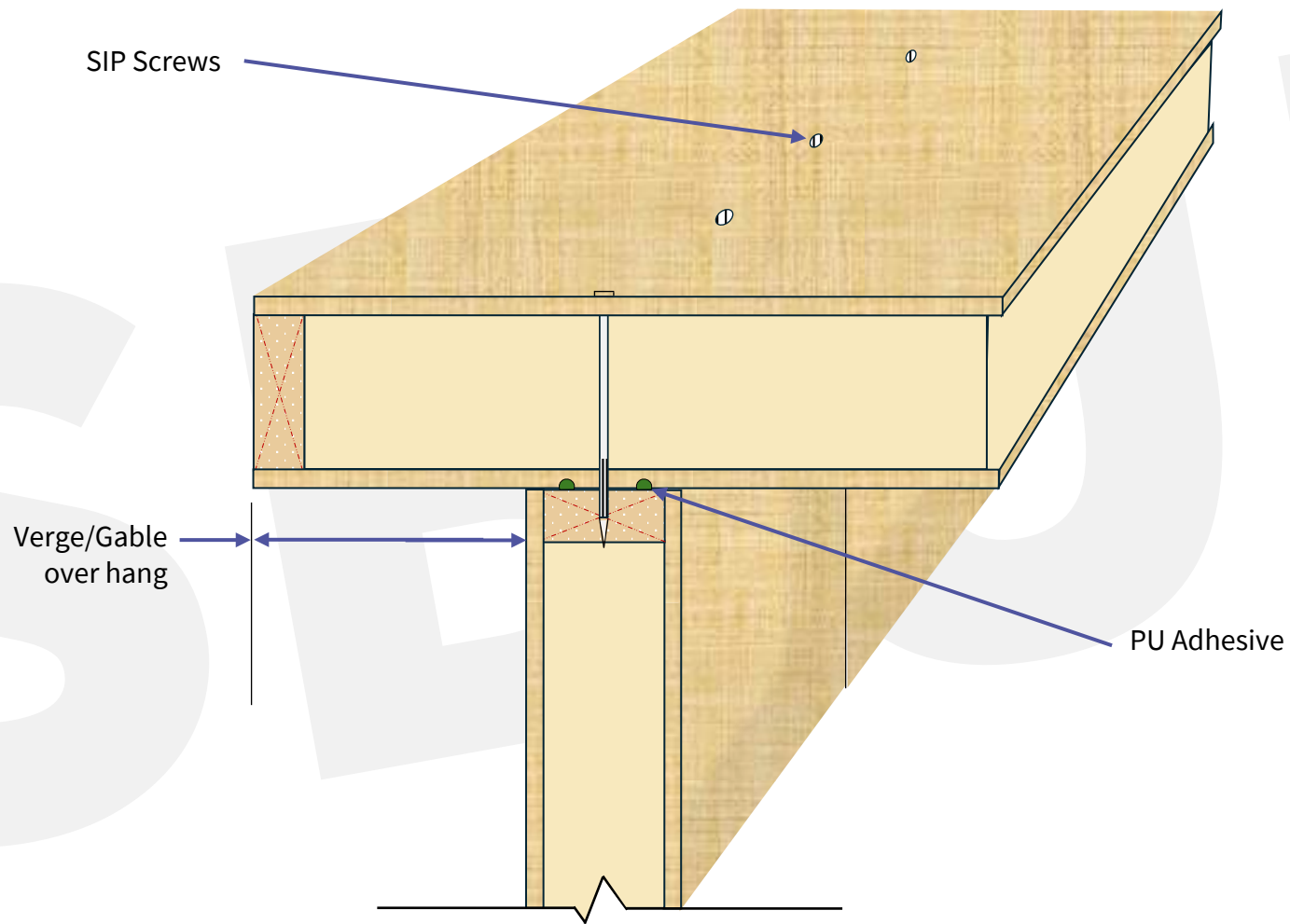

ALL FIXINGS SUBJECT TO  
ENGINEERING

\*Details should be considered indicative only. Intellectual Property of SBUK.